

Congratulations on the purchase of your Utility Vehicle! These instructions will guide you through the assembly process. Carefully read these instructions and familiarize yourself with the tools and fasteners required before starting the assembly of your vehicle.

The following fasteners are included for the assembly of this vehicle. please make sure you have all fasteners before beginning assembly. If any parts are missing or if you have questions regarding the packaged vehicle, call American Landmaster customer service at 800-643-7332.

Bag contents

Overhead bars / Bed tubes (black bag)

- (8) - 5/16-18 x 2 Socket yellow (2-50172)
- (8) - 5/16 Bent washer zinc (2-50702)
- (8) - 5/16-18 Nylon LN yellow (2-50007)

Steering wheel (clear bag)

- (6) - 1/4-20 x 3/4 Socket SS (2-50636)
- (6) - 1/4-20 Nylon LN yellow (2-50001)

Bumper (red bag)

- (4) - 5/16-18 x 1.25 Hex head bolt (2-50161)
- (4) - 5/16-18 Keps lock nut yellow (2-50005)
- (4) - 5/16 SAE flat washer yellow (2-50701)

Cargo Bed (clear bag)

- (2) - 5/8-11 x 4 HHCS Gr.8 yellow (2-50255)
- (2) - 5/8-11 Nylon LN yellow (2-50015)

Seat Belt (yellow bag)

- (2) - M12 x 1.75 x 25 FHCS (15829)
- (2) - M12 x 1.75 x FH toplock hex nut (2-50001)

Fenders (white bag)

- (4) - 1/4-20 x 1 HHCS Gr.5 zinc (2-50087)
- (4) - 1/4-20 Nylon LN yellow (2-50001)
- (4) - 1/4 SAE flat washer yellow (2-50717)
- (4) - 1/4-20 x 3/4 Carriage bolt Gr.5 zinc (2-50087)

TOOLS REQUIRED



Hammer	Box or Side Cutter	Pry Bar
Safety Glasses	1/2" Wrench	1/2" Socket
1/4" Allen Wrench	Phillips Screw Driver	7/16" Wrench
3/16" Allen Wrench	(2) 15/16" Wrench	(2) 17mm Wrench

⚠ WARNING

Wear proper eye protection during the uncrating and assembly process to avoid potential eye injuries.

⚠ WARNING

RISK OF SERIOUS INJURY OR DEATH

The Brush Bars and the Shoulder Belts are critical parts of the Operator / Passenger safety system on this vehicle. Do not attempt to operate the unit until these components have been properly installed.

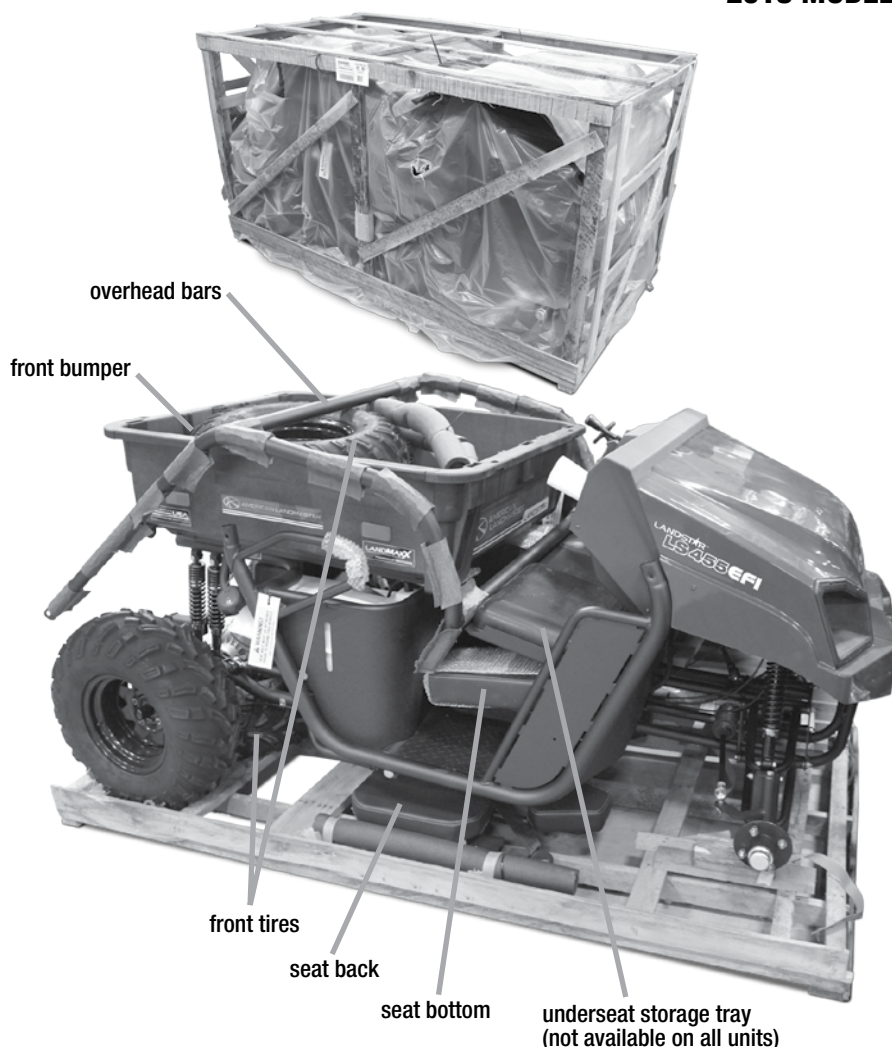

1 Uncrating the vehicle (refer to figure 1)

- Wear your Safety Glasses to prevent eye injury.
- Using the Hammer and Pry Bar, remove crate ends and discard.
- Carefully pry and remove crate top and discard.
- Remove crate sides and discard.
- Using a Box Cutter, cut and remove the hold down ties.
- Unpack all loose components and set aside.

Figure 1
Typical crate construction

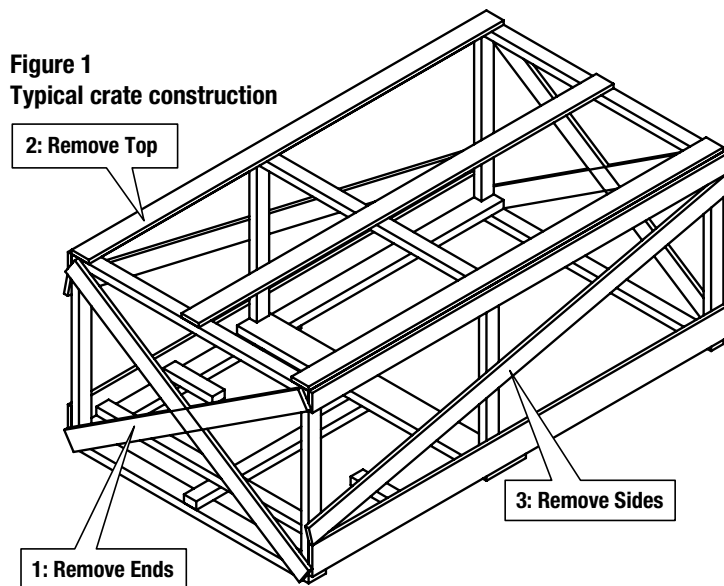

2 Front Wheel Installation (refer to exploded view at right)

- 1) Jack the front of the vehicle up so that the front wheels can be installed.
- 2) Secure the vehicle with jack stands.
- 3) Install the front wheels using the lugnuts that are shipped on the front wheel hubs.
- 4) Use care when installing the wheels such that the **valve stem is facing the outside of the vehicle**. As well, some models are equipped with directional tires and should be installed in the **direction indicated by the arrow on the sidewall of the tire** as shown at right.
- 5) Install the lug nuts with the **tapered side against the wheel**. Tighten each lug nut and torque to 100 ft-lb ft.
- 6) Remove the jackstands. The vehicle can now be rolled off of the crate base.

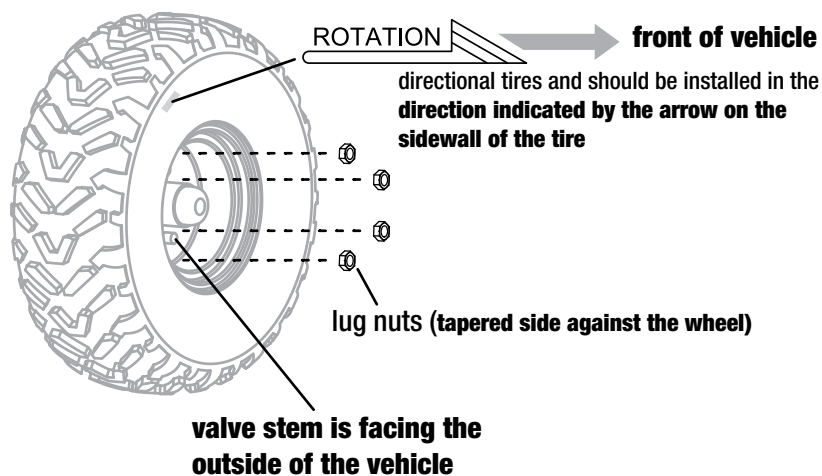

3 Bumper Installation (refer to exploded view at right)

- 1) Align the holes in the front bumper with the mounting plate on the front of the vehicle.
- 2) Insert the four 5/16" x 1" bolts through the bumper brackets and into the mounting plate with the **washers and lock nuts on the BACK of the mounting plate**.
- 3) Install the four washers and locknuts and tighten.

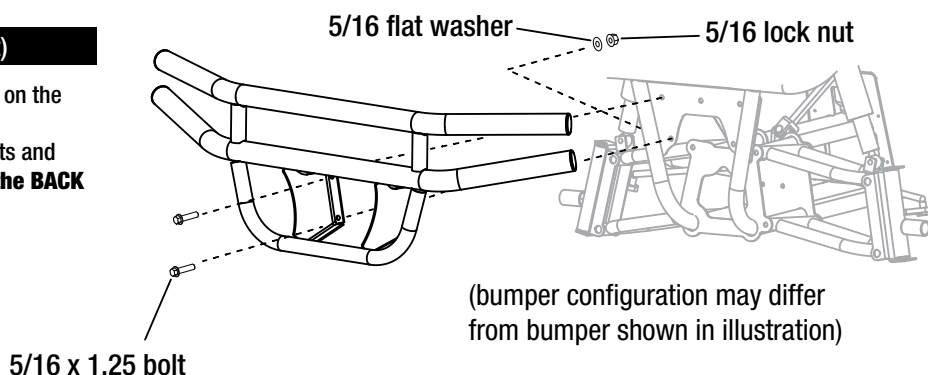

4 Steering Wheel Installation (refer to exploded view at right)

- 1) Turn the front wheels such that the tires are pointed straight forward. Align the holes in steering wheel with mounting holes on the steering hub such that the **center spoke is pointing down**.
- 2) Install 1/4" x 3/4" socket head bolts through the center cap, then into the steering wheel and steering hub. Install and tighten 1/4" **nylon locking nuts on the back of the steering hub**.

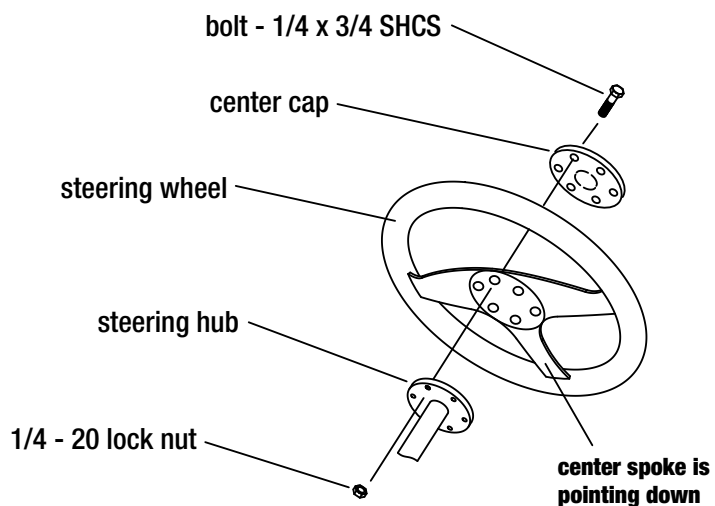

5 Overhead Bar Installation (refer to exploded view at right)

- 1) Place seat back assembly on vehicle frame as shown.
- 2) Place the A Pillar weldment on the vehicle frame as shown.
- 3) Insert the 5/16" x 2" socket head bolts through the 6 connection points as shown. The head of the bolt should be on the **outside of the vehicle**.
- 4) Install the curved washers on the threaded end of the bolts such that the curve **fits snugly against the tube**.
- 5) Install the 5/16" nylon locking nuts - leaving all fasteners **finger tight**.
- 6) Once all overhead fasteners are installed, tighten all fasteners.

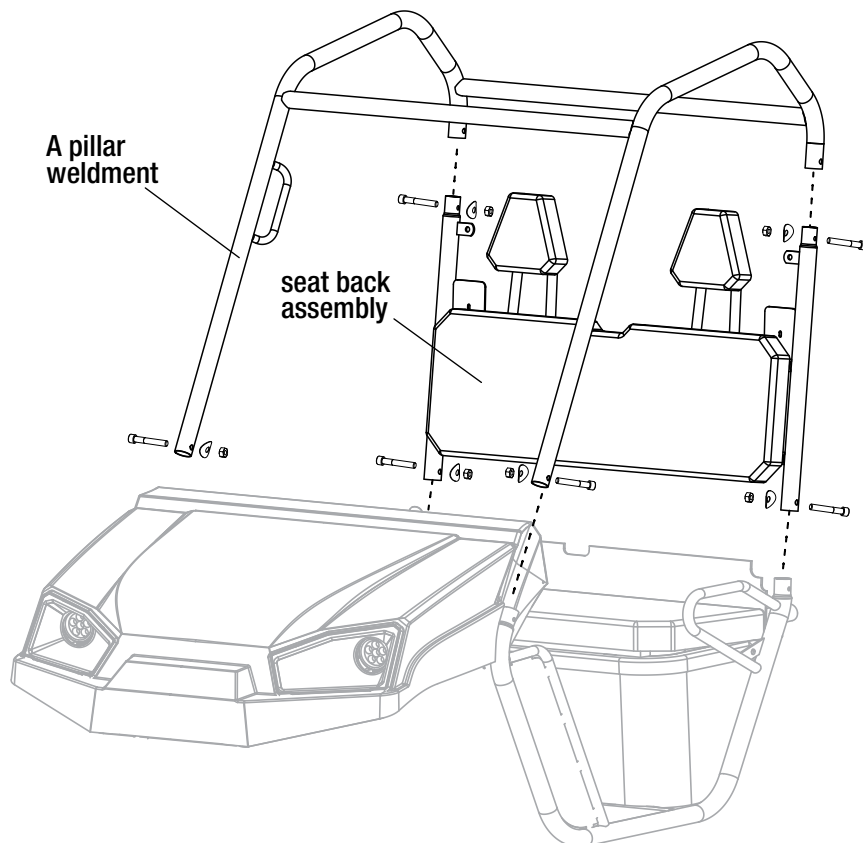

6 Cargo Bed Installation (refer to exploded view at right)

- 1) Locate and install rear the frame stub tubes into the rear of the frame. **Note that the pivot tube on the frame stub tube should be on the top side when installed.**
- 2) Insert a 5/16" x 2" socket head bolt **from the top down** into the frame stub tube.
- 3) Install the curved washer such that it forms to the tube, then install a 5/16" center lock nut (**do not tighten until after cargo bed is installed**)
- 4) Place the cargo bed on the vehicle and insert a 5/8" x 4" hex head bolt through each pivot bracket and frame stub tube. **The bolt heads should be facing the center of the vehicle with the nuts facing the outside.**
- 5) Tighten both 5/16" frame stub bolts and nuts.
- 6) Install the 5/8" nylon locking nuts on the pivot bolts. **Tighten the pivots and then loosen 1/4 turn.**
- 7) Loosen the bed latch pin bolt on the frame just enough for it to slide in the adjustment slot.
- 8) Close the bed and position the latch pin bolt so that it is at the **bottom of the latch slot** to prevent rattles. Tighten the latch pin.

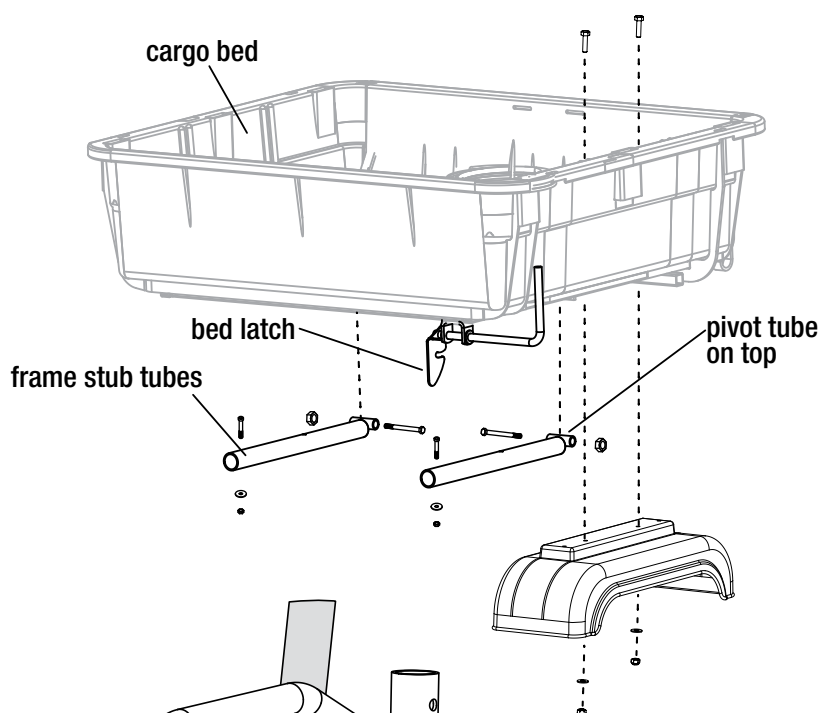

8 Rear Fender Installation (refer to exploded view at right)

- 1) Tilt the cargo bed up.
- 2) Line up the holes in the rear fenders with the square holes in the bed. The raised rectangular surface on **the fender should be completely hidden under the bed**. If not, turn the fender around.
- 3) Insert a 1/4" x 1" hex head bolt through the bed and into the fender.
- 4) Fasten with a 1/4" flat washer and a 1/4" nylock. (**If installing fenders on a steel bed, you will use 1/4" x 3/4" carriage bolts instead of the hex head bolts**).

9 Safety Belt Installation (refer to exploded view at right)

- 1) From the outside of the vehicle working inboard, pass the M12 x 25 bolt through the outside hip point mounting bracket and the seat belt anchor.
- 2) Install the M12 flanged locking nut and tighten.
- 3) Repeat on the other side.

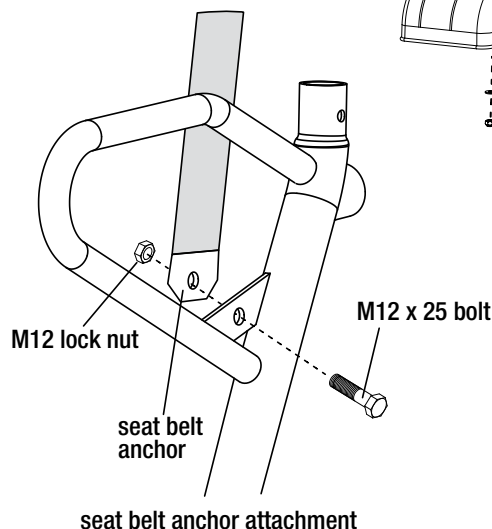

⚠ WARNING

Avoid risk of serious injury or death. It is important to first read and understand the Owner/Operator Manual and follow all instructions and warnings. If you do not understand this, or any other warning supplied with your vehicle, contact your dealer or ALM customer service at 1-800-643-7332 before using this vehicle

EXPLODED VIEW

