

BUMPER & BED INSTALLATION GUIDE

BUMPER INSTALLATION



**TWO PEOPLE RECOMMENDED
FOR ASSEMBLY**



15min

TOOLS:

- 10mm Driver / Extended Socket
- 10mm Wrench

HARDWARE:

- 4qty Bolts - 2-50161
- 4qty Nuts - 2-50005
- 4qty Washers - 2-50704

STEP #1

Have a second person help to hold up the bumper and align it to the 4 holes on the chassis. Slide a washer over each bolt and insert them through the bumper plate and onto the chassis. Fasten each bolt with a nut. Tighten down with your driver and hold the nut in place with a wrench.

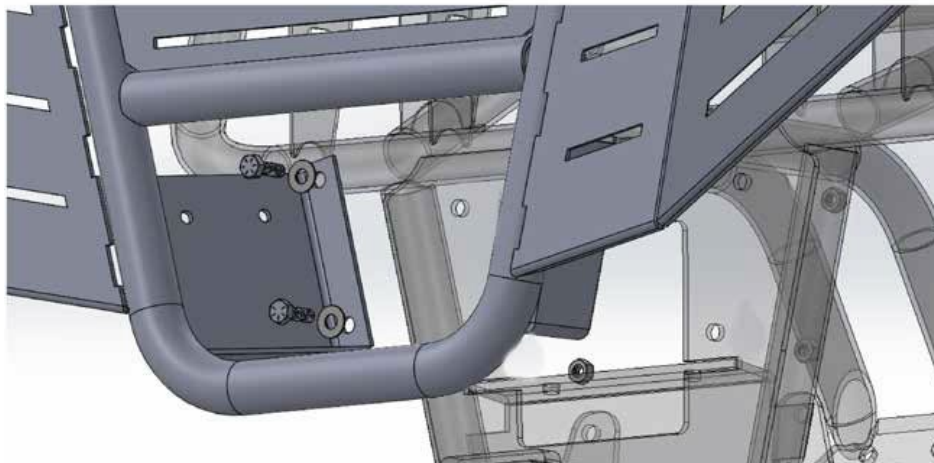
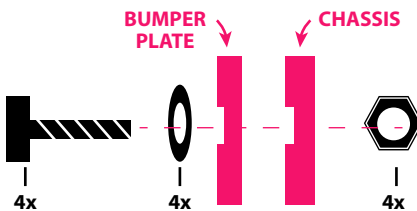
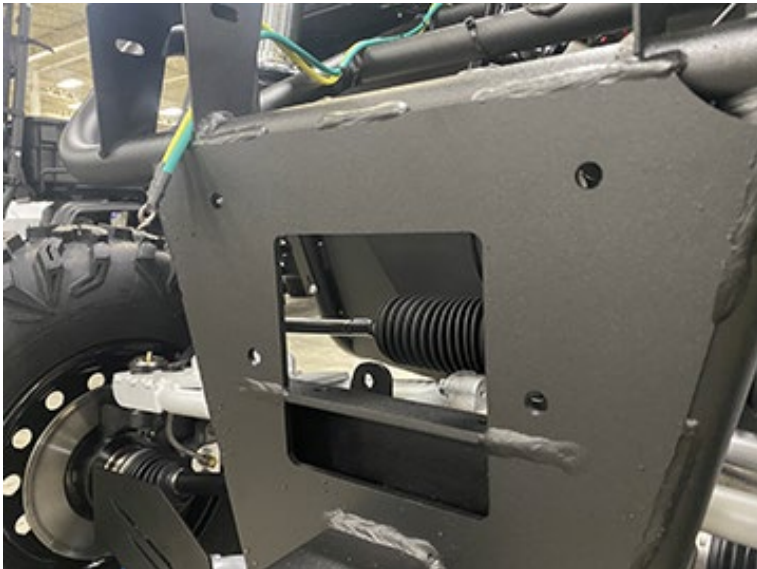

BED INSTALLATION



**TWO PEOPLE RECOMMENDED
FOR ASSEMBLY**



15min

TOOLS:
(none required)
Use 9/16" Wrench For Bed Latch
Adjustment If Necessary

HARDWARE:
- 2qty Clevis Pin - 17661
- 2qty Retaining Clip - 17660

STEP #1

Place bed on chassis using a second person to help you lift the bed. Allow the latches to pass through to the latch bolts.



STEP #2

Lift the rear of the bed to align the bed mount to the chassis mount.

Run the clevis pin into each side of the bed. Attach the retaining clips to prevent pins from sliding out.



STEP #3

Adjust the driver side and passenger side bed latch bolts using a 9/16" wrench or socket as necessary to take out any play in the bed.

