



## HOOD RACK KIT (16829)

THIS KIT IS USED ON NEWER STYLE FULL SIZE UTV  
LANDSTAR / TRAILWAGON / CROSSROAD MODELS

### Installation information:

- This product has an installation rating of: **Easy**
- Approximate installation time: **30 Minutes**
- This product is easiest to install with: **2 people**

#### As illustrated below, this kit contains:

2 Piece Basket  
Front riser/Light Mounting Plate  
Bumper Mount clamp (2)  
Front clamp (2)  
Rear clamp (2)  
ROPS clamp (L,R)  
Extendable Tubes (2)  
Front riser stems (2)  
Front riser caps (2)

#### Hardware:

(8) M6 20mm Button Head Bolts  
(1) M6 30mm Button Head Bolt  
(1) M6 35mm Button Head Bolt  
(4) M6 25mm Button Head Bolts  
(4) M6 25mm Socket Head Bolts  
(4) M8 35mm Socket Head Bolts  
(24) M6 Flat Washers  
(12) M6 Lock Nuts

TOOLS REQUIRED	
10mm Wrench	#4 Allen Wrench
#5 Allen Wrench	#6 Allen Wrench
Phillips Head Screwdriver	Tape Measure

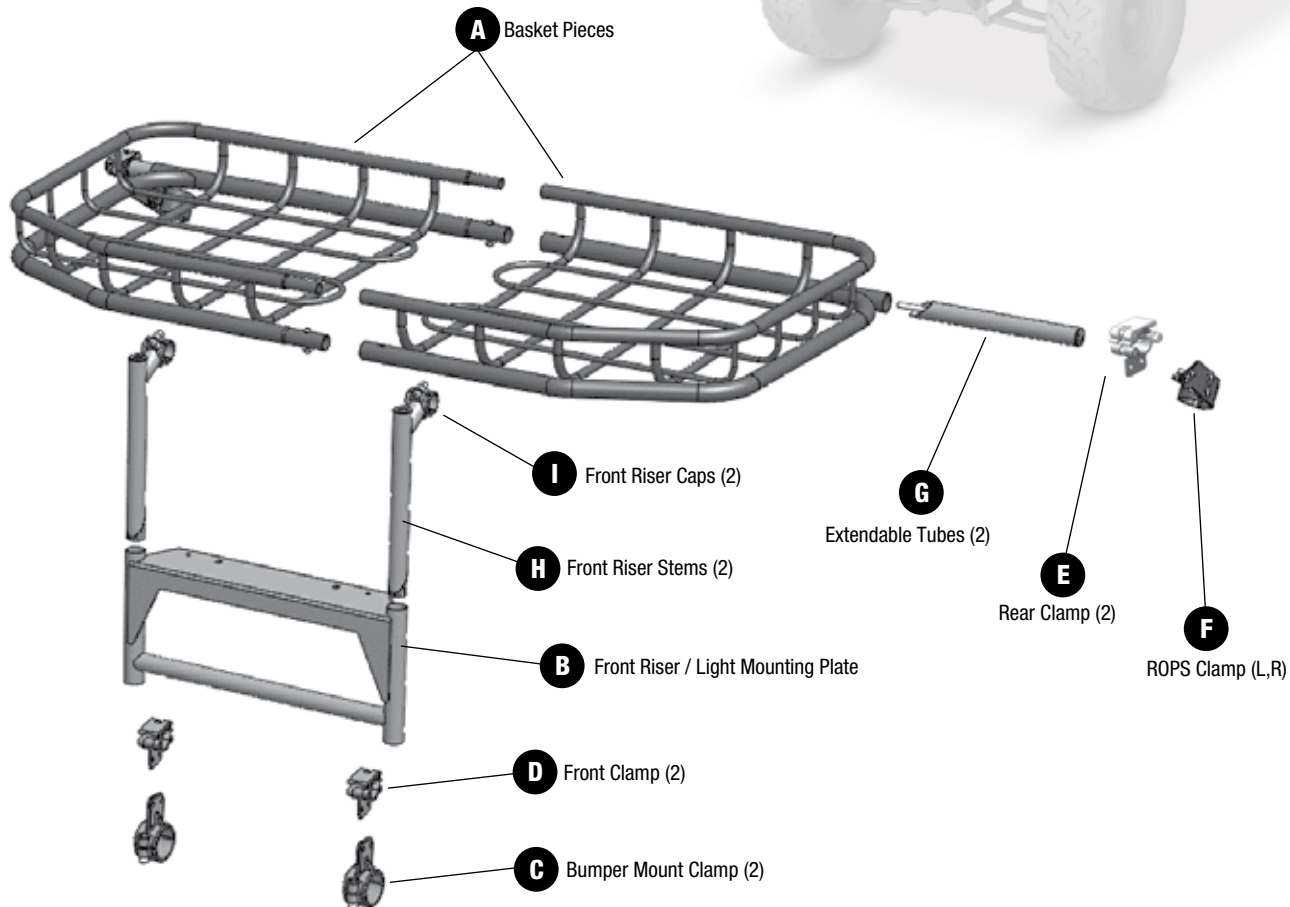

**CAUTION**

**DO NOT** load the Hood Rack with more than 75lbs or damage may occur.



- 1** Assemble two sides of rack using a #4 allen wrench and 10mm wrench. Secure the back of the rack with a single M6 35mm socket head bolt and lock nut. Secure the front of the rack with a single M6 30mm socket head bolt and lock nut.

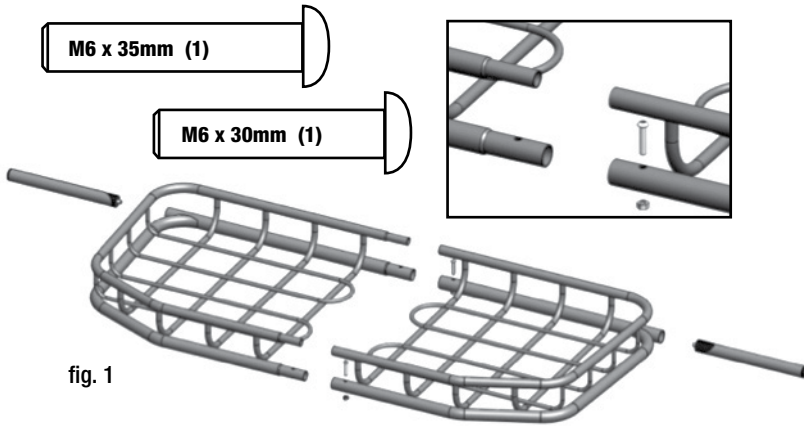

- 2** Insert the two (G) extendable tubes in the ends of the hood rack as shown in figure 2. Tighten bolts at the ends with a 6mm Hex key just enough to hold tube in place. You will tighten **after** final assembly.

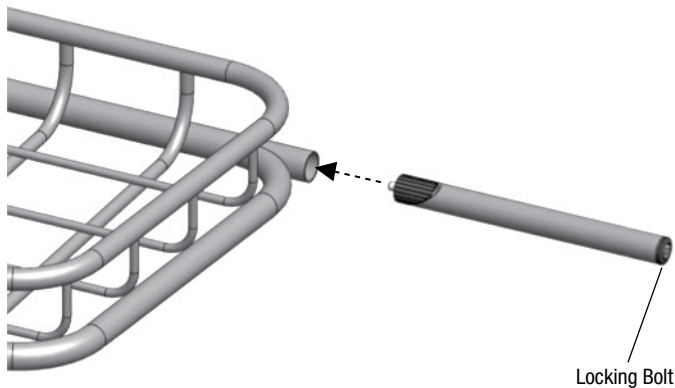

## CLAMP ORIENTATION AND ADJUSTMENT

To open a clamp, lift up on both levers in the order above. Orient all clamps so the first clamp lever opens towards the front of the vehicle. To increase clamping force, Using a phillips head screwdriver, rotate the lever screw clockwise; to decrease the clamping force, rotate the lever screw counter-clockwise before locking. **Do not over tighten. Spin lever should be able to close using your hand. Do not try to force it closed with a mallet or any other tool.**

**CAUTION**  
refer to figure 3

Rotate lever screw to adjust clamping force

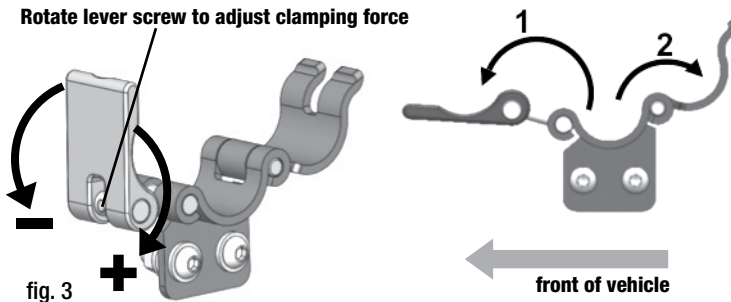

## BUMPER MOUNT AND FRONT CLAMP ASSEMBLY

- 3** Using a #4 allen wrench and 10mm wrench, attach the two front clamps (D) to the bumper mount clamp (C) using (4) M6 x 20mm button head bolts, (8) washers and (4) locknuts. Make sure all clamp levers open away from the vehicle. Refer to figure 4.

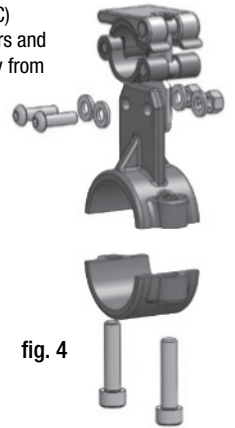

- 4** Using a #6 allen wrench, attach the two bumper mount clamps on the bumper Using (4) M8 x 35mm socket head bolts inboard of the 2 bumper upright tubes as shown in figure 5.

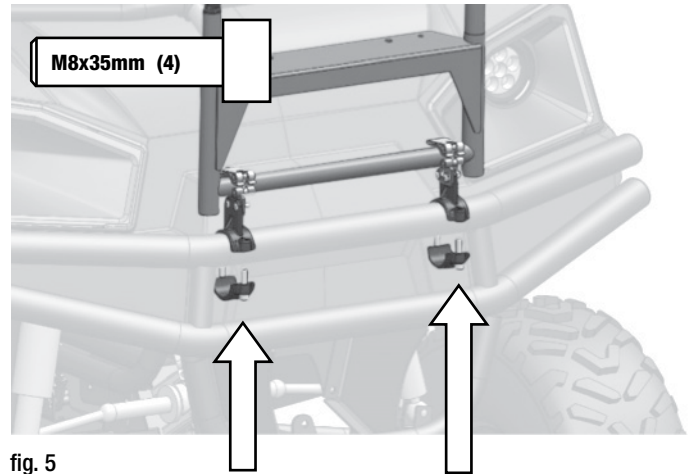

- 5** Place the 2 ROPS clamps (E) 5.5 inches up from the ROPS tube joint as shown in the figure 6.

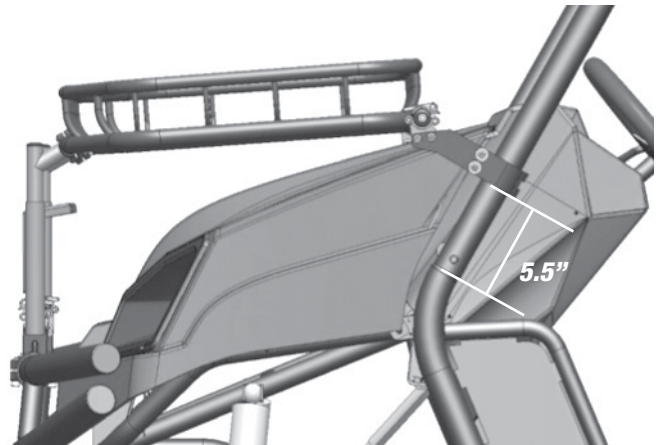

fig. 6



- 6** Using a #4 allen wrench and 10mm wrench, Attach the ROPS Clamps (F) to the sides of the roll cage with (4) M6 x 25mm button head bolts as shown in figure 7.

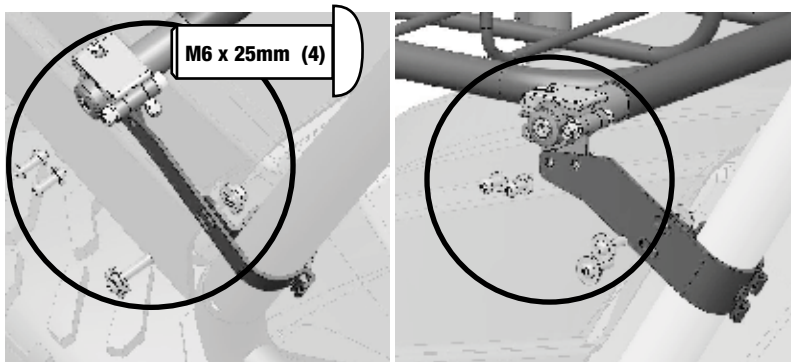
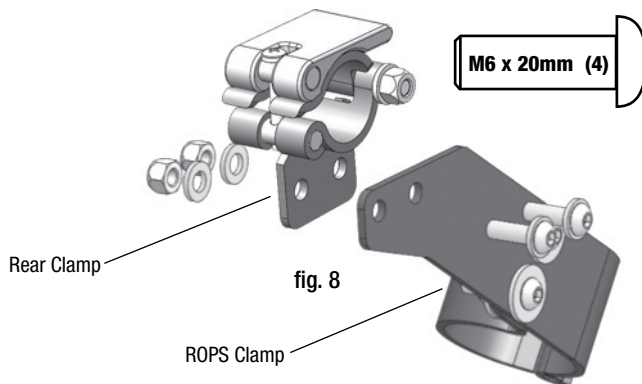

fig. 7

- 7** Using a #4 allen wrench and 10mm wrench, attach the two rear clamps (E) to the ROPS clamp (F) with two M6 x 20mm button head bolts, 4 washers and 2 nuts as shown in figure 8. The clamp lever should open towards the front of the vehicle.



## RISER ASSEMBLY

- 8** Note the riser orientation shown below in figure 9. Insert the 2 Front riser stems (H) into the front riser / light mounting plate a few inches in. Tighten the locking bolt at the top of the tube with allen wrench just enough to hold the riser stems in place. You will tighten **after** final assembly.

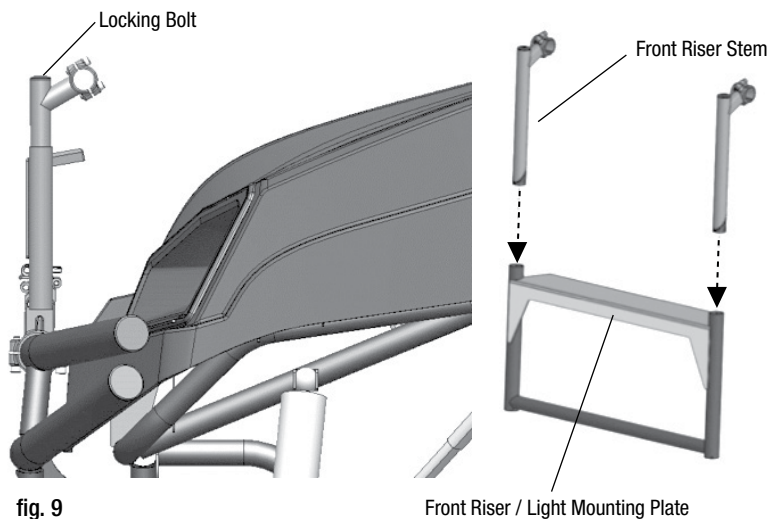

fig. 9

## BASKET INSTALLATION AND ADJUSTMENT

- 9** Attach the riser assembly to the front of the hood rack and bolt the two front riser caps in place as shown in figure 10. Using a #5 allen wrench, snug the cap bolts, but keep them loose enough to allow rotation. Make sure all 4 clamps are open, then set the rack in place.

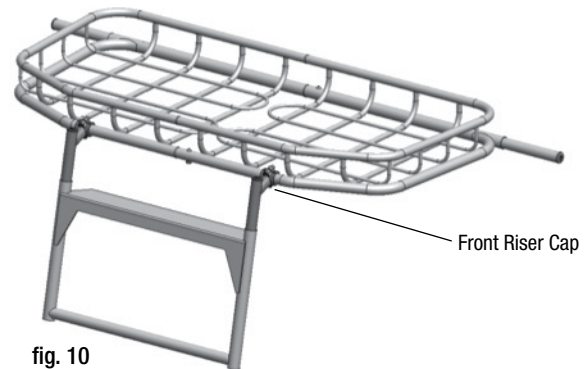

fig. 10

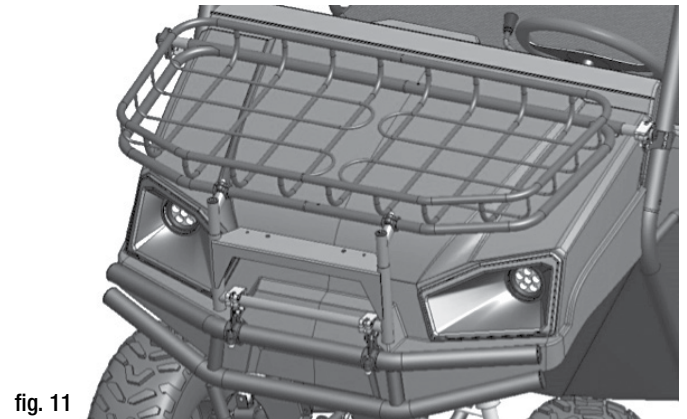

fig. 11

- 10** Adjust the width of the extendable tubes (G) so they stick out just past the clamps as shown below. The hood rack angle can be adjusted by loosening the bolt on the front riser stems and lifting up or pushing down on the front of the rack. Adjust clamps and brackets as necessary, then tighten all bolts. We recommend no more than 5% of slope to the hood rack.

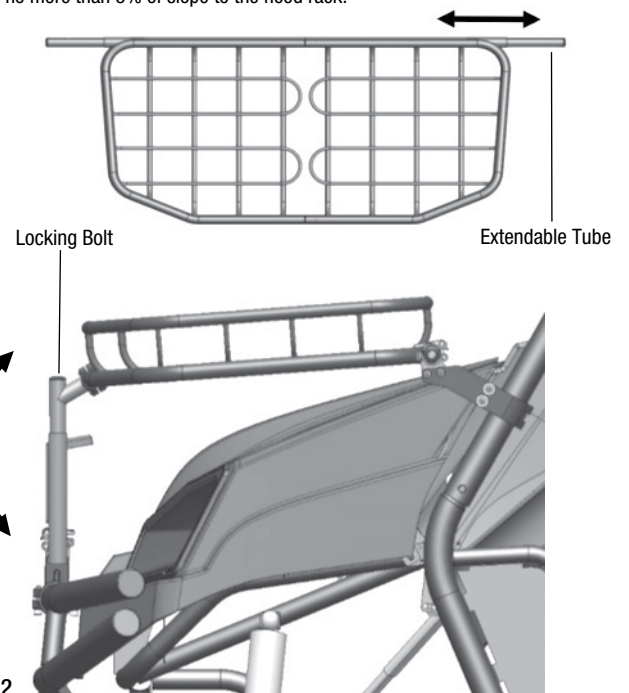

fig. 12