

**Kit PN 18925-R Work & Ride Light Package - For Standard Cab Models**  
**Kit PN 18926-R Work & Ride Light Package - For Crew Cab Models**  
**19145 Installation Guide, Work & Ride Light Package**  
**SPECIAL REQUIREMENTS: This Guide covers Standard Cab and Crew Cab**

TOOLS REQUIRED		ESTIMATED INSTALL TIME	RECOMMENDED SKILL LEVEL
Wire Cutters	Philips Screw Driver	2 Hours	Intermediate
4 mm Allen Wrench	Flat Screw Driver		
General Purpose Pliers	1" Hole Saw		
5/16" Drill Bit	Two ½" Wrenches		

Before you begin, check the contents of the kit against the parts list below. Immediately contact American Landmaster with any questions or discrepancies. American Landmaster cannot assume responsibility for any damage or injury resulting from incorrect installation of parts. American Landmaster suggests that accessory kits be installed by an authorized American Landmaster dealer or service center.

## !! WARNING !!

**Serious Injury or death could occur!**

- Use proper personal protective equipment during installation of this kit. Use safety glasses.

### PARTS LIST FOR AMERICAN LANDMASTER ACCESSORY KIT

- |   |                       |                       |  |                          |             |
|---|-----------------------|-----------------------|--|--------------------------|-------------|
| (1) Roof Harness                                | (1) Dome Light Switch | (1) Work Light Switch | (1) Work Light                                     | (1) Flood Light          | (2) Grommet |
| (1) Bag of Brackets & Bolts for the Flood Light |                       | (15) Tie Wraps        | (1) Dome Light                                     | (1) Dome Light Trim Ring |             |
| (1) Dome Light Bracket                          | (2) #8 Screw          | (2) #8 Lock Nut       | (1) Crew Cab Work Light Extension 18926-R Kit Only |                          |             |
| (1) ¼ " Bolt (1.25" long)                       | (1) ¼" Flat washer    | (1) ¼" Lock Nut       | (12) Tie wraps                                     |                          |             |

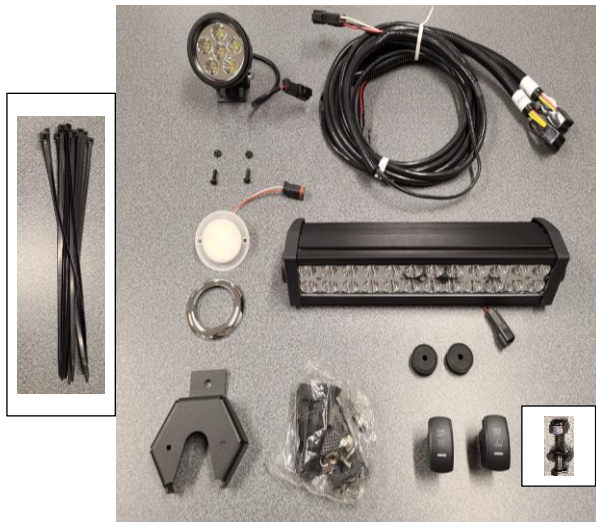

Figure 1 –Kit contents – 18925-R & 18926-R



Figure 2: Included in 18926-R Crew Cab Kit - Work Light Extension

## Preliminary Dis-Assembly Instructions:

- 1- Remove the hood. Remove three screws from each front fender and two screws from the front hood using the 4 mm Allen wrench. Lift the hood off and set aside. If the vehicle has turn signals, disconnect the amber lights by depressing the release tab on each turn signal lamp connector and pull apart. Set the hood aside where it will not be damaged.



Figure 3: Removing Three Fender Fasteners



Figure 4: Removing Two Hood Fasteners

- 2- Remove the Black Instrument panel cover. Unscrew each stainless steel fastener that holds down the black instrument panel cover using a 4 millimeter Allen wrench. Place the fasteners in a small container so they do not get lost. Lift the cover straight up and off the panel. Set the cover aside where it will not get damaged.



Black Instrument  
Panel cover

Figure 5: Removing Black Instrument Panel Cover



- 3- Remove the tunnel cover. Remove six bolts from the cab top side. Clamp nuts are used for easy removal and installation. If you have a crew cab, remove the rear tunnel cover as well.



Figure 6: Tunnel Cover Installed



Figure 7: Tunnel Cover Removed

- 4- Remove the driver seat.

Lift up on the rear of the seat to remove. Lift the seat up and out of the vehicle. Set it aside in a safe place. Do not place the seat next to sharp surfaces that could puncture the covering.

- 5- Remove the seat back cover

Remove the rear cover by pulling out on the cover from the center to get it to bow out and come out from behind the vertical frame tubes.

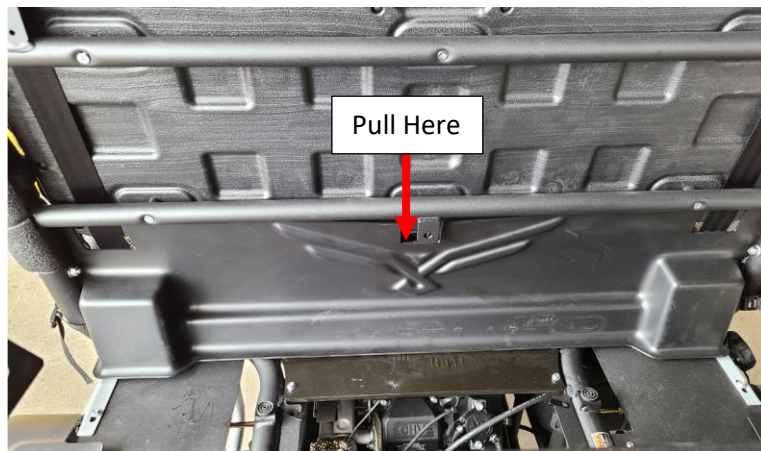

Figure 8: Remove Rear Seat Back cover



## Dome and Work Light Switch Installation:

- 1- Remove two available switch blanks from the bank of the seven switch plate. Push the blanks out from the back of the plate.
- 2- Insert the Dome Light and Work Light rocker switch into the open spots. Push the switches into the hole until it clicks into position.



Figure 9: Seven Switch Plate in Instrument Panel



Figure 10: Seven Switch Plate with Switches Added

## Flood Light Installation:

- 1- Assemble the flood light by installing the side brackets on the lamp body with the hex head bolts provided. An Allen wrench is also provided in the flood light box. Do not tighten the side bracket bolts at this time.



Figure 11: Lamp assembled with side brackets

- 2- Place the lamp assembly on the front brow of the roof. A flat spot is provided. Center the lamp on the roof.



Figure 12: Mounting location for the lamp



- 3- Using a marker, mark the two holes that are to be drilled for mounting the lamp.
- 4- Put the lamp assembly aside and drill out the two mounting holes in the roof using a 5/16" drill.
- 5- Attach the lamp to the roof with the bolts provided in the lamp box.



**Figure 13: Flood light positioned and mounted in the Center of the Roof brow**

- 6- Position the lamp's harness connector straight behind the lamp mounting bolt and mark a spot to drill a hole in the roof. The lamp harness and connector must be able to reach through the hole with the grommet.
- 7- Using a 1" hole saw, drill a hole through the roof behind the lamp mounting bolt as shown below.



**Figure 14: 1 inch hole drilled in the roof**

- 8- Locate a 1" grommet provided in the package.
- 9- Open the split in the grommet and slide it over the flood light cable. Ensure that the beveled edge of the grommet is pointing down such that it would be first to penetrate the roof.



Figure 15: Grommet is attached to lamp cable

- 10- Slide the grommet up or down the wires such that there is an adequate length of harness to allow the lamp to be adjusted up or down on the top side of the roof.
- 11- With the grommet around the lamp wires, start pushing the grommet into the hole by starting at the split. Use a medium size flat screw driver to press the grommet into the hole.



Figure 16: Grommet is started into the mounting hole

- 12- When complete, the grommet will be fully seated into the hole and produce a water resistant seal.

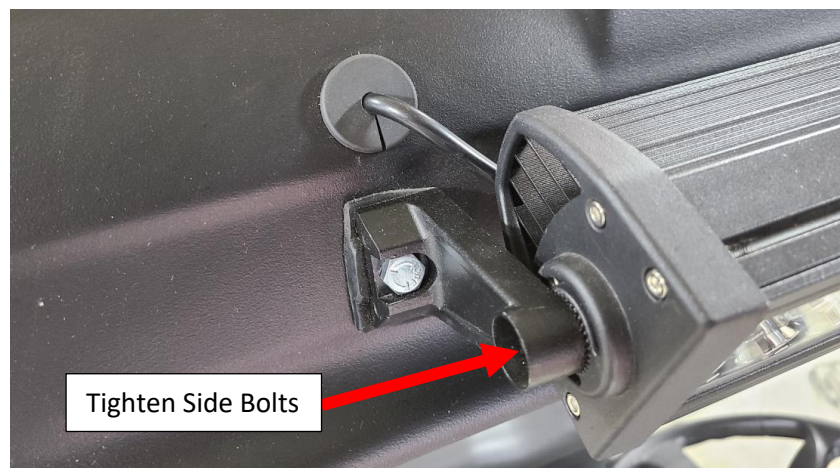

Figure 17: Grommet is fully seated in the mounting hole. Tighten Side Bolts after Aiming Light





13- Aim the flood light to the desired angle.

14- Tighten the lamp side bolts on both sides to secure the position with the Allen wrench.

## Work Light Installation:

- 1- Locate the Work Light from the kit. Find the center of the roof on the rear of the vehicle and mark it.
- 2- Drill two holes in the rear brow of the roof on the center mark. The upper one requires a 1 inch hole saw. The lower one requires a 5/16 inch drill bit. Drill the holes on the down sloping area of the rear of the roof. Distance between the hole centers is 2 inches.



Figure 18: Holes drilled for the work lamp on the rear of the roof

- 3- Bolt the work light to the lower hole with the bolt provided with the lamp using the pair of ½ inch wrenches. Make sure the bracket is parallel to the roof edge.



Figure 19: Work Light bolted to the roof

- 4- Locate a 1" grommet provided in the package.
- 5- Open the split in the grommet and slide it over the work light cable. Ensure that the beveled edge of the grommet is pointing down such that it would be first to penetrate the roof.
- 6- Slide the grommet up or down the wires such that there is an adequate length of harness to allow the lamp to be adjusted up or down on the top side of the roof.
- 7- With the grommet around the lamp wires, start pushing the grommet into the hole by starting at the split. Use a medium size flat screw driver to press the grommet into the hole.
- 8- When complete, the grommet will be fully seated into the hole and produce a water resistant seal.

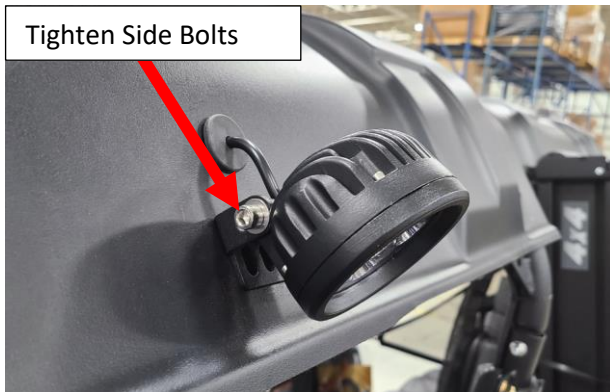

Figure 20: Grommet is fully seated on a Standard Cab

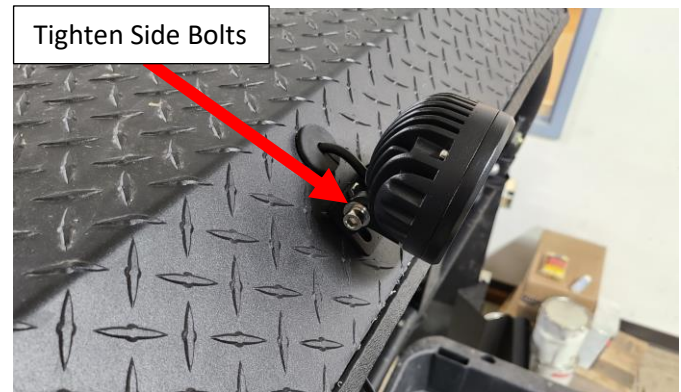

Figure 21: Grommet is fully seated on a Crew Cab

- 9- Aim the work light to the desired angle.
- 10- Tighten the lamp side bolts on both sides to secure the position with the Allen wrench provided.

#### Electrical Harness Installation for the Standard Cab:

(See the section labeled Electrical Harness Installation for Crew Cab if applicable)

#### Routing the Rear Portion of the Harness

- 1- Start the harness installation by laying the harness on the front cab tunnel with the blue four pin connector positioned forward toward the dash panel.
- 2- First, route the jacketed cable & three connectors rearward through the tunnel and exit on the driver side in the seat frame area.
- 3- Continue the installation of the roof harness by continuing to route the harness around the driver's seat frame as shown below.
- 4- Loosely tie wrap the harness to the seat frame at each major tube structure.
- 5- Tie wrap the harness a few inches lower from the seat frame top near the corner to keep it clear from the seat retainer hook.

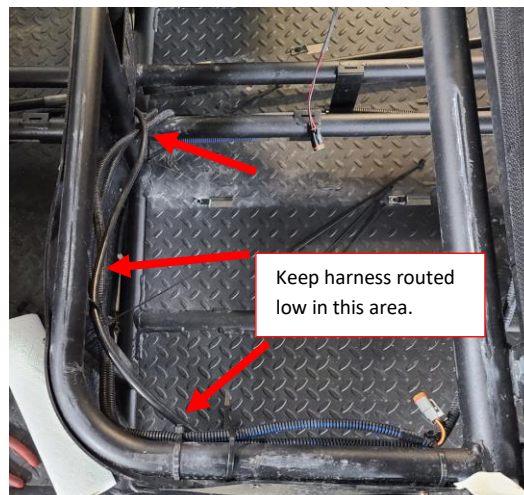

Figure 22: Electrical Harness Tie Wrapped in Place





7. Next route the jacketed cable and connectors under the rear seat frame tube and start routing it up the back side of the driver side rear pillar tube. Use the three Christmas tree tie wraps that are provided on the harness to attach it to holes provided in the seat back frame. Loosely attach with tie wraps on the upper roof rail. Route the two connector pair to the middle of the upper rear frame tube and loosely tie wrap.

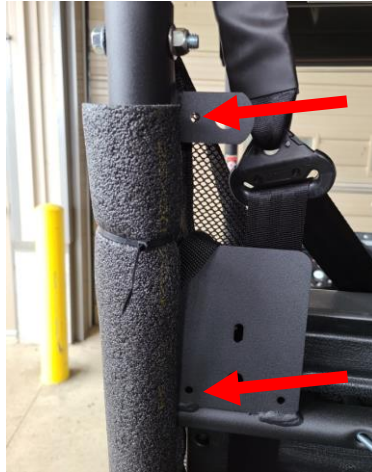

Figure 23: Cable Routed up the rear pillar    Figure 24: Upper Tie Wrap Points    Figure 25: Lower Tie Wrap Point

- 8- Take the remaining connector along the upper passenger side frame tube to the front of the cab with loosely attached tie wraps. Route this connector in front of the roof tube and one third of the way across the front of the cab.



Figure 26: Flood Light harness routed along the passenger side of roof

- 9- Connect the single connector at the end of the harness to the flood light connector protruding through the roof.
- 10- Tie wrap the mated flood light connector pair to the nearby frame tube. Do not just tie wrap to the harness.

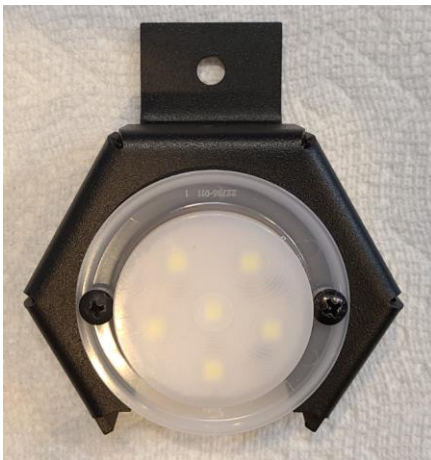

**Figure 27: Flood light attached to the end of the harness**

- 11- Once this connection is made, begin to do final harness routing and tighten tie wraps as you back up through the installation. Tie wrap clipping starts here at the flood light. Keep the harness flat to the tubing as you tie wrap it tight.
- 12- Ensure that the dome light and work light connectors are positioned in the center of the rear top rail and tight wrap tightly.
- 13- Back up and position the jacketed cable across the upper rear rail and down the rear B pillar. Tighten the tie wraps as you go. If there is extra length, let it be stowed under the seat.
- 14- Finally tighten the tie wraps in the seat frame area.
- 15- Cut off the extra tie wrap tails with the wire cutters.

#### **Dome Light Installation:**

- 17- Attach the Dome Light to the dome light bracket using the #8 screws and nuts. Snap on the chrome trim ring when complete.



**Figure 28: Dome Light Attached to Bracket**



**Figure 29: Dome Light Trim Ring Snapped ON**



- 18- Remove the roof bolt next to the dome light connectors. On the standard cab, the same bolt will be used to attach the work light and the dome light. On a crew cab, a bolt in the center of the roof near the upper rail will be used.
- 19- Remove the bolt and the clamp nut from the roof bracket. On standard cab use the bolt provided with the Work Light to retain the Dome Light. On a Crew Cab, use the black 1.25 inch bolt and lock nut to retain the dome light provided in the kit.
- 20- Connect the dome light connector to the roof harness connector. Hide the mated connector pair inside the dome light bracket housing. Install the bolt to capture the dome light and tighten with a pair of half inch wrenches.
- 21- Route the dome light harness through the opening next to the mounting tab,



Figure 30: Dome Light Mounted in a Standard Cab



Figure 31: Dome Light Mounted in a Crew Cab

## Routing the Front Portion of the Harness

- 1- Feed the front end of the harness with the blue four pin connector up through the hole in dash panel in the tunnel area.
- 2- Locate the blue four pin connector in the instrument panel harness that mates with the Work & Right Light harness.

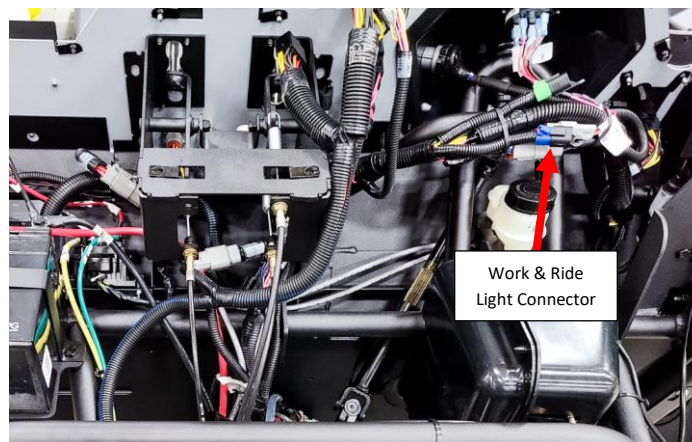

Figure 32: Work & Ride Light Connector with Cap

- 3- Remove the connector cap by depressing the release tab on the cap and pull off of the harness. **DO NOT PULL OFF THE CAP BY PULLING ON THE WIRES.** Use one hand on each side of the connector pair.
- 4- Connect the Work & Ride Light harness connector to the blue instrument panel harness connector until you hear a click.





- 5- Tie wrap the Work & Ride Light harness to the engine harness in the front dash panel area.
- 6- Attach the harness to the Dome Light switch and the Work Light switch.
- 7- Be sure to install the harness on the switches in the correct orientation. Line up the hook on the switch with the latch on the harness connector. The hook is on the bottom side of the switch. Place one hand on the front of the switch while installing the harness connector from the rear. A rocking motion will make installing the harness connector easier. Ensure that the connector is lined up with the switch and do not bend the switch pins. Do not force the connection. Push the harness connector onto the switch until the two meet with no gap between them. Each harness connector has a feature label. Mate up with corresponding switch.
- 8- Cut off tie wrap tails with the wire cutters when complete.

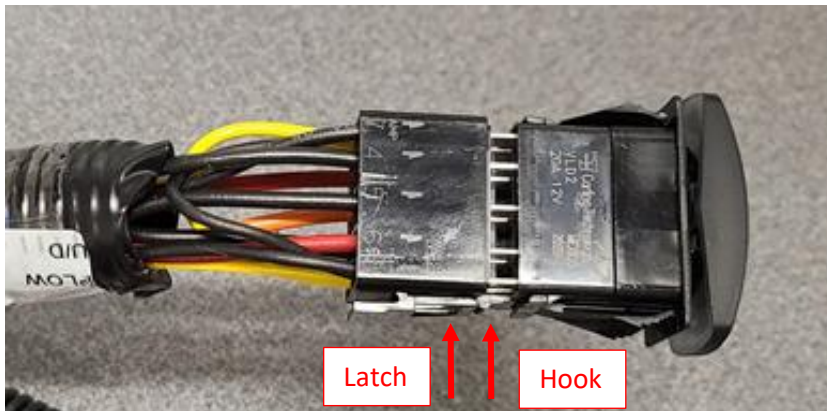

Figure 33: Ensuring Switch Orientation with the Harness Connector



Figure 34: Harness Labels for switch functions

## Work & Ride Light Harness Installation for the Crew Cab

- 1- Installation in a crew cab is exactly the same as the standard cab except for the installation of the work light extension cable.  
A common roof harness is used for all vehicles, but the crew cab requires an extension cord to reach the work light.



Figure 35: Work Light Extension Harness for Crew Cab

- 2- Install the main Work & Ride Light cable in the crew cab the same as the standard cab described above.
- 3- Once that is completed, take the two wire extension harness from the kit and attach it to the black two pin connector on the main roof harness on the center of the top rail near the dome light location.



**Figure 36: Work Light Extension attached to the Roof Harness**

- 4- Route the extension cable to the passenger side and follow the side rail to the back of the vehicle. Loosely attach tie wraps about every twelve inches.
- 5- Connect the extension harness to the black two pin Work Light Connector.
- 6- Route harness flat to the tubing and tighten the tie wraps.
- 7- Cut off the tie wrap tails with wire cutters.
- 8- Installation of the Work and Ride Light Feature is now complete.



**Figure 37: Extension harness routed to side rail**



**Figure 38: Extension harness attached to the Work Light**

### **Testing the System:**

- 1- The Work & Ride Light feature only works with the ignition key in the ON position.
- 2- Push the upper portion of the Work Light switch.
- 3- Verify that the work light comes ON. Verify that the indication of ON bar illuminates in the lower portion of the switch.
- 4- Push the upper portion of the Dome Light switch.
- 5- Verify that the dome light comes ON. Verify that the indication of ON bar illuminates in the lower portion of the switch.
- 6- Push the head light switch to the middle position.
- 7- Verify that the head lights come on and that all the switch back lights all illuminate.
- 8- Push the head light switch to the upper position.
- 9- Verify that the head lights and overhead flood light comes on.



AMERICAN  
**LANDMASTER**

Toll Free 800-643-7332 • Toll Free Fax 800-399-1399 [www.AmericanLandmaster.com](http://www.AmericanLandmaster.com)

# INSTALLATION INSTRUCTIONS

---

## **Reassembly:**

- 1- Reinstall the seat.
- 2- Reinstall the back of cab (seat back) trim panel.
- 3- Reinstall the tunnel cover(s).
- 4- Reinstall the black instrument panel cover.
- 5- Reinstall the hood. Be sure to hook up the front turns signals, if equipped.